

Data sheet

# SonoSelect 10 and SonoSafe 10 Energy Meters

Description



The Danfoss SonoSelect 10 and SonoSafe 10 are ultrasonic compact energy meters intended for measuring energy consumption in heating, cooling and combined heating and cooling applications for billing purposes. The meters are designed for remote meter read-out (AMR).

The energy meters consist of an ultrasonic flow sensor, a pair of Pt1000 temperature sensors and a calculator with integrated circuits for temperature measurement, flow calculation and energy calculation.

**Feature highlights:**

- Proven ultrasonic measuring principle designed for long operating life time
- No calming section or inlet/outlet restrictions
- Low pressure drop down to 0.03 bar at  $q_p$
- Large 85 x 35 mm LCD display with 8 digits (11.5 mm high), guiding menu and info panel
- Compact design
- Extensive change and error log
- Memory: 4 years of data, yearly and monthly values stored (incl. pulse input)
- Upgradable with communication modules in bracket (dual M-Bus, connection with water meter)
- Power supply 3.6V battery (replacable) or 230V mains power
- Communication baud rate 300, 2400, 4800 and 9600 bps
- SonoApp usable for Android (Bluetooth LE via dongle)

Special features:	SonoSelect 10	SonoSafe 10
Battery	• 16 + 1 years battery life (from production date)	• 10 + 1 years battery life
Flexibility	<ul style="list-style-type: none"> <li>• Heating or cooling or combined heating and cooling</li> <li>• Supply and return can be configured on site</li> <li>• Energy units can be configured on site</li> <li>• Slot for communication upgrade</li> <li>• 1.5 m cable PUR between calculator and flow sensor allow for flexible installation, e.g. in flat stations</li> </ul>	<ul style="list-style-type: none"> <li>• Heating</li> <li>• Energy units can be configured on site</li> <li>• Slot for communication upgrade</li> <li>• 0.5 m cable PVC between calculator and flow sensor</li> </ul>
Safe	<ul style="list-style-type: none"> <li>• EN1434 class 2 + flow and energy calculated every 0.5 second</li> <li>• Tamper monitor sets alarm if meter is opened by unauthorized personnel</li> <li>• Diagnostic function to secure confidence in meter data</li> <li>• IP65 calculator</li> <li>• Reverse flow indication</li> </ul>	<ul style="list-style-type: none"> <li>• EN1434 class 2 + flow and energy calculated every 2 seconds</li> <li>• IP54 calculator</li> </ul>
SonoApp	<ul style="list-style-type: none"> <li>• Installer tool (Guides and configure e.g. AMR, Pulse, units, supply/return)</li> <li>• Commissioning tool (Link location to serial number)</li> <li>• Operation tool (walk by + diagnostics)</li> <li>• Tariff function can be added via SonoApp</li> </ul>	<ul style="list-style-type: none"> <li>• Installer tool (Guides and configure e.g. AMR, Pulse, units)</li> <li>• Operation tool (walk-by)</li> <li>• Commissioning tool (Link location to serial number)</li> <li>• Tariff function can be added via SonoApp</li> </ul>

**Technical specifications,  
Complete energy meter**

Application	Heating, cooling or combined heating and cooling	
Medium	Water quality with pH 7 to 9.5 VDI 2035, VdTÜV TCh 1466	
Approvals, heating	EN1434 class 2 and 3, MID (DK-0200-MI004-034), CPA according to JJG225 -2010	
Approvals, cooling	Denmark: TS 27.02 010, Switzerland: METAS CH-T2-17763-01, Germany: PTB 17-22.001-DK, Austria: BEV-13.426_0078-E2_2017	
Measuring cycle	Flow: 0.5 sec. (SonoSelect 10), 2 sec. (SonoSafe 10) Energy: 0.5 sec. (SonoSelect 10), 2 sec. (SonoSafe 10) Temperature: 4 sec. (SonoSelect 10), 10 sec. (SonoSafe 10)	
Approved meteorological range	$\Delta\theta$ : 3 - 90K	$\theta$ : 5 - 95°C
Temp. limits (energy calculation)	$\Delta\theta$ : 0.25 - 100K	$\theta$ : 0 - 105°C
IP	65 (SonoSelect 10), 54 (SonoSafe 10)	
Cable strain relief	Withstand more than 5 kg	
Ambient operating temperature	Class A: 5 - 55° C indoor installation non condensing	
Ambient storage temperature	-25 - 60° C	
Temperature media	5 - 95° C	
Mechanical environment	Class M2	
Electromagnetic environment	Class E1	

**Technical specifications,  
Calculator**

Power supply	3.6 V DC lithium battery (2 AA SonoSelect 1 AA SonoSafe), Mains supply 230V AC	
Battery life time*	16+1 years (SonoSelect 10), 10+1 years (SonoSafe 10)	
Mains Supply	Voltage of Alternating Current	230V AC
	Upper and lower voltage tolerance	+10%/-15%
	Alternating current voltage frequency	50/60 Hz
	Power consumption	< 2.5VA
	Output	3.6V DC
	Backup supply	Integral SuperCap eliminates interruptions of Energy meter due to power failures for up to 60 Min.
	Cable gland	M12
Mains supply cable	2 wire with PHR3-2 connector for Mains supply	
Display	85 x 35 mm LCD display with 8 digits (11.5 mm high main characters) Menu guide and info panel 16 years of operation at qp, 45K without display overflow	
Units	MWh - kWh - GJ - Gcal - °C - K - m³ - m³/h - l/h	
Memory	2 years of data, yearly and monthly values stored (incl. pulse input)	
Optical interface	Optical acc. to EN62056-21. Data protocol acc. to EN13757-3, supports 2400 or 4800 baud.	
Communication	Wired M-Bus to EN13757-3, supports 300, 2400, 4800, 9600 baud. Delivered with 1 m cable (SonoSelect 10: PUR, SonoSafe 10: PVC) Serial number: <b>sssssvNnyWW</b> (addressing) <b>ss</b> : Primary address, <b>yWWsssss</b> : Secondary address	
Additional communication	1 slot for communication module (delivered from factory or later upgrade)	

\* Battery life time measured under following preconditions: enclosure temp. 45° C, communication every 15 min. at 2400 baud or faster, 80 meters on bus. Please contact Danfoss for further information.

**Technical specifications,  
Flow sensor**

DN	15	15	20	20	25	25	25	32
Nominal flow qp (m³/h)	0.6	1.5	1.5	2.5	3.5	3.5	6.0	6.0
Max flow qs (m³/h)	1.2	3	3	5	7	7	12	12
Minimum flow (1:100) qi* (m³/h)	0.006	0.015	0.015	0.025	0.035	0.035	0.06	0.06
Cut off flow qc (m³/h)	0.0012	0.003	0.003	0.005	0.007	0.007	0.012	0.012
Overflow qss (m³/h)	1.32	3.3	3.3	5.5	7.7	7.7	12.3	12.3
Pressure drop (at qp 50°C)	30	150	150	160	130	130	220	220
Kvs values ( $\Delta p=Q_2/Kvs^2$ )	3.46	3.87		6.25	9.71	9.71	12.79	
Connection	G3/4" 110mm		G1" 130mm		G1¼" 160mm	G1¼" 260mm	G1¼" 260mm	G1½" 260mm
Pressure PN (bar)	16 bar							
IP [EN60529]	65							
Temperature limits (°C)	0 to 105							
Cable length	1.5m (SonoSelect 10: PUR), 0.5m (SonoSafe 10: PVC)							
Mounting	Any position, no inlet or outlet restrictions							

\* (1:250) qi on request

**Technical specifications,  
Temperature sensor**

Type	Pt1000 direct short, 2 wire
Size	Diameter: Ø5.2 mm, length: 26 mm
Nipple	M10 x 1 mm brass, with pin lock
Cable length	1.5 m
Accuracy	Class B (EN60751)
Temperature range	Θ: 0 - 105° C (SonoSelect 10), 5 - 95° C (SonoSafe 10)
IP	65
Approved temp. range to EN60751	Θ: 0 - 105° C
Difference temp. EN60751	ΔΘ: 3 - 105K
Pressure	25 bar

**Communication  
modules**
**Modules in general**

To adapt the meter for various applications SonoSelect 10 and SonoSafe 10 features a slot for mounting communication modules. Each module features its own  $\mu$ -controller and is powered by its own battery. Modules have their own parameter set which is saved in the module  $\mu$ -controller flash memory. A local copy of the energy meter parameters used for communication is stored in the module. Data from module is updated in meter every 10 minutes.

Power: Lithium Thionyl Chloride battery (half of AA size) or Mains power supply (230 V).

2 pulse in/outputs have common ground.

Modules are galvanically isolated from main Energy Meter circuitry.

**Wired M-Bus module with 2 pulse inputs**

Once installed the meter will display the icon for wired communication and pulse inputs in loop 2 of the display.

Wired M-Bus is galvanically isolated from  $\mu$ -controller and pulse inputs.

The two pulse inputs can be programmed independently of each other (see specification for pulse input module).

M-Bus (primary)	Lithium Thionyl Chloride battery (half of AA size)
M-Bus (secondary)	M-Bus supply
Baud rate supported	300, 2400, 4800, 9600
Communication protocol	According to EN1434-3 & EN13757-3
Battery life time	16+1 year
Addressing	Serial number: <b>sssssvvNNyyWW</b> <b>ss</b> : Primary address, <b>yWWsssss</b> : Secondary address

**Wireless OMS communication module, 868.95MHz with 2 pulse inputs**

Once installed the meter will display the icon for wireless communication and pulse inputs in loop 2 of the display. The two pulse inputs can be programmed independently of each other (see specification for pulse input module).

Standard	Open Metering System (OMS) issue 4.0.2
Frequency	868.95 MHz
Antenna	Internal
Transmission power	10mW (Max. 25mW; 13,9 dBm)
Mode	T1 mode
Encryption	AES 128 bit encryption (mode 5), Parameterized Static key
Sending interval	Fixed network: 15 min.
Telegram	Standard telegram*
Battery life time	16+1 year (with pulse inputs off)
Addressing	Serial number: <b>sssssvvNNyyWW</b> <b>yWWsssss</b> : Secondary address

\* See section with data telegram.

**2 pulse input module**

Once installed the meter will display the icon for pulse inputs in menu 2 of the display. Accumulated volume is only readable by communication. The two pulse inputs can be programmed independently of each other.

Pulse value	0.001 m <sup>3</sup> to 1 m <sup>3</sup> per pulse
Voltage supply	≤ 6.0 V
Source current	≤ 0.1 mA
High level input threshold	≥ 2 V
Low level input threshold	≤ 0.5 V
Pull-up resistor	100 kΩ
Pulse length	≥100 ms
Maximum frequency	≤ 5 Hz
Pulse inputs	According to EN1434-2, section 7.1.5 (Classification of pulse input devices Class IB)
Battery life time	16+1 year

\* Suitable for both electronic switch and Reed contact.

**Communication modules** *(continuous)*

**2 pulse output module**

Once installed the meter will display the icon for wired communication in menu 2 of the display.

Pulse 1 (energy*)	+ terminal 16, - terminal 17
Pulse 2 (volume*)	+ terminal 18, - terminal 19
Pulse value*	Unit follow the display. Scaling follow least significant digit of the display (default setting can be changed via SonoApp)
Pulse timing	Updates every 15 seconds
Polarity reversal:	Not possible, but can withstand -30V, max 27 mA without damage
Pulse length	≥100 ms
Pulse Pause:	≥100 ms
Voltage supply	3-30 V
Source current	≤ 27 mA
"ON" condition	$U < 2,0 @ 27mA$
"OFF" condition	$R \geq 6 M\Omega$
Maximum frequency	≤ 5 Hz
Pulse outputs	According to EN1434-2, section 8.2.3 (Classification of pulse output devices Class OB)
Battery life time	16+1 year
Cable length	Max 25 m
Alarms	E32 activates in meter if: 1) Module battery is empty 2) When no. of delayed pulses exceeds 5000 (incorrect scaling)

\*Default setting. Can be changed via SonoApp

**Data telegram**

<p><b>Wired M-bus</b> Standard telegram (16 seconds if mains powered):</p> <ul style="list-style-type: none"> <li>Accumulated Energy (heat and cooling for bifunctional)</li> <li>Accumulated Volume (heat and cooling for bifunctional)</li> <li>Current flow</li> <li>Current power</li> <li>Supply temperature</li> <li>Return temperature</li> <li>Difference temperature</li> <li>Enclosure temperature</li> <li>Current time</li> <li>Hour counter factory</li> <li>Hour counter OK</li> </ul>	<p><b>Wireless M-bus (OMS)</b> Standard telegram fixed network (15 minutes sending interval, 16 seconds if mains powered):</p> <ul style="list-style-type: none"> <li>Accumulated Energy (heat and cooling for bifunctional)</li> <li>Accumulated Volume (heat and cooling for bifunctional)</li> <li>Current power</li> <li>SupplyTemperature</li> <li>ReturnTemperature</li> <li>CurrentTime</li> </ul>	<p><b>Wireless M-Bus (Walk -by)</b> Standard telegram Walk by (2 minutes sending interval, 16 seconds if mains powered):</p> <ul style="list-style-type: none"> <li>Accumulated Energy (heat and cooling for bifunctional)</li> <li>Accumulated Volume (heat and cooling for bifunctional)</li> <li>CurrentTime</li> <li>Hour counter factory</li> <li>Month log 1 (last month log)</li> </ul>
--	---	--

\* Can be changed via SonoApp

**Tarif function**

The main register is considered the legal billing register.  
Tarif 1 and 2 can be configured to accumulate either energy or volume independently.  
The unit related to upper and lower limit always follow the unit related to condition.

**Tarif configuration (Tarif 1 & 2)**

1. Energy
2. Volume

**Tarif condition (Tarif 1 & 2)**

1. Power
2. Flow
3. Temperature difference
4. Temperature Supply
5. Temperature Return
6. Time
7. Volume x Temperature Supply
8. Volume x Temperature Return
9. Power x volume

**Tarif condition limits (Tarif 1 & 2)**

1. Upper value
2. Lower value

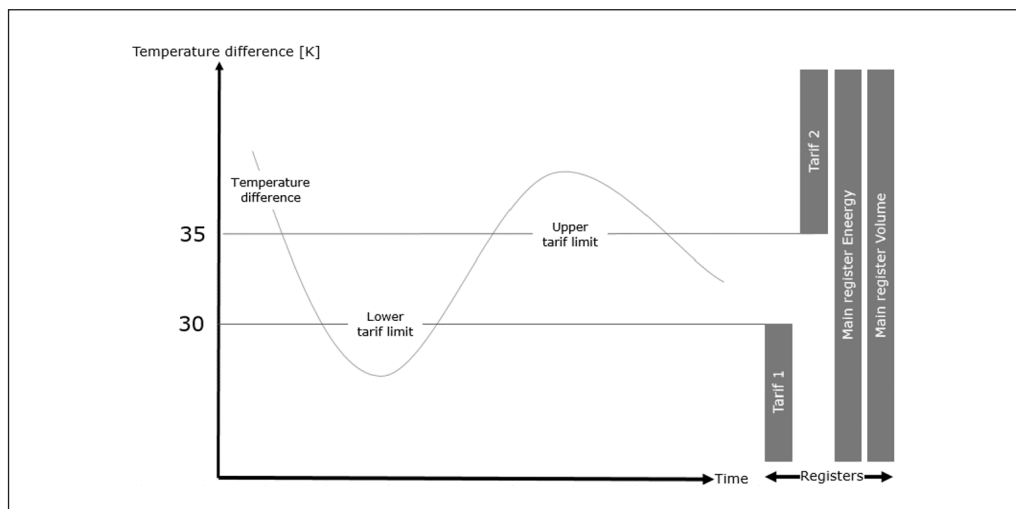

**Bifunctional meters**

Bifunctional meters are for combined heating and cooling applications.  $\theta_{hc}$  default value is 30°C it can be configured with SonoApp.

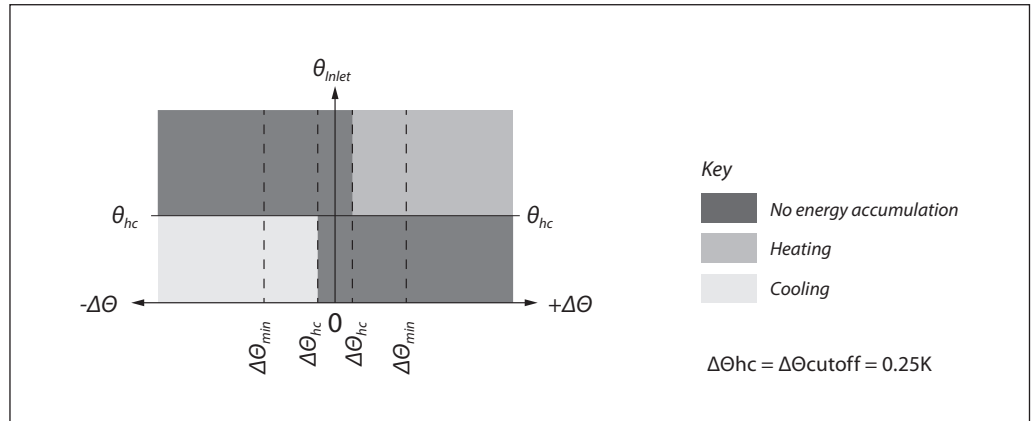

**Application drawings**

Heat meters have red temp sensor in supply pipe and all cooling meters have blue temp sensor in supply pipe

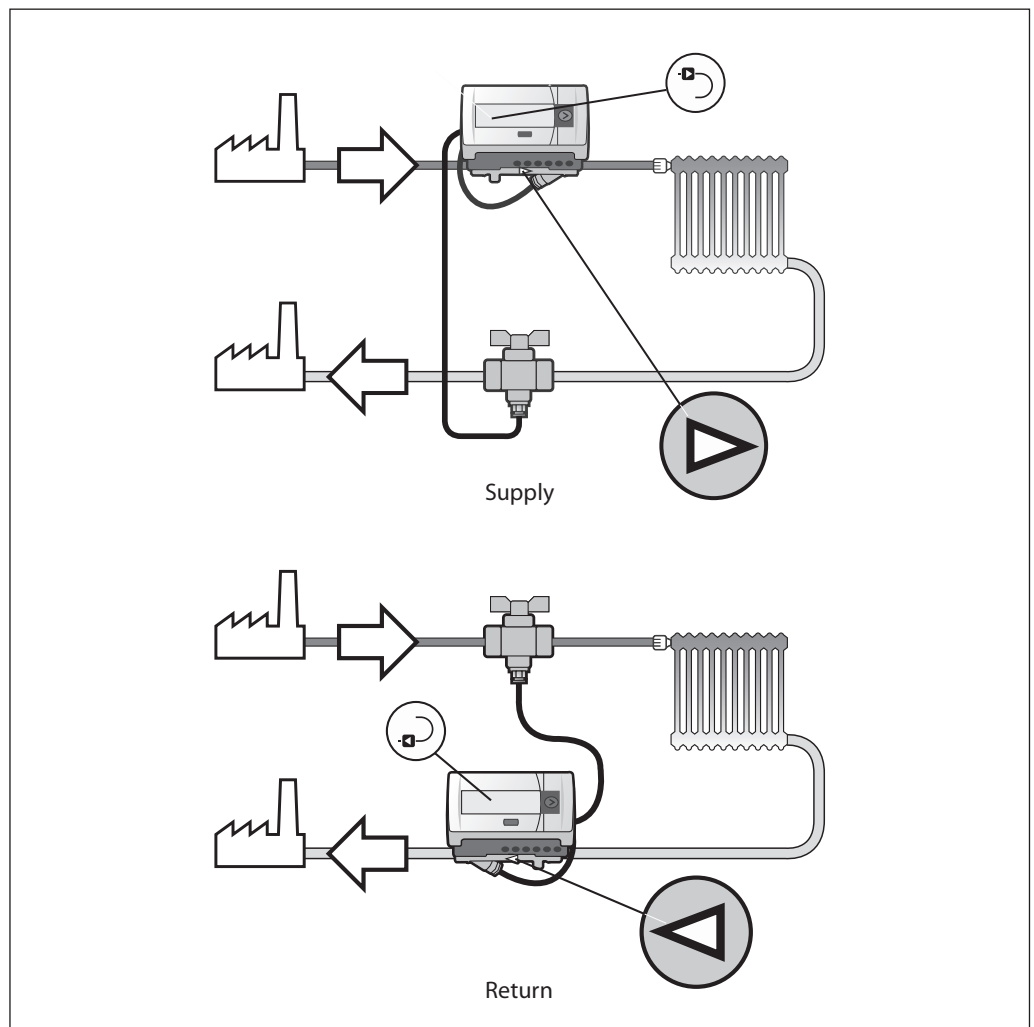

Accuracy

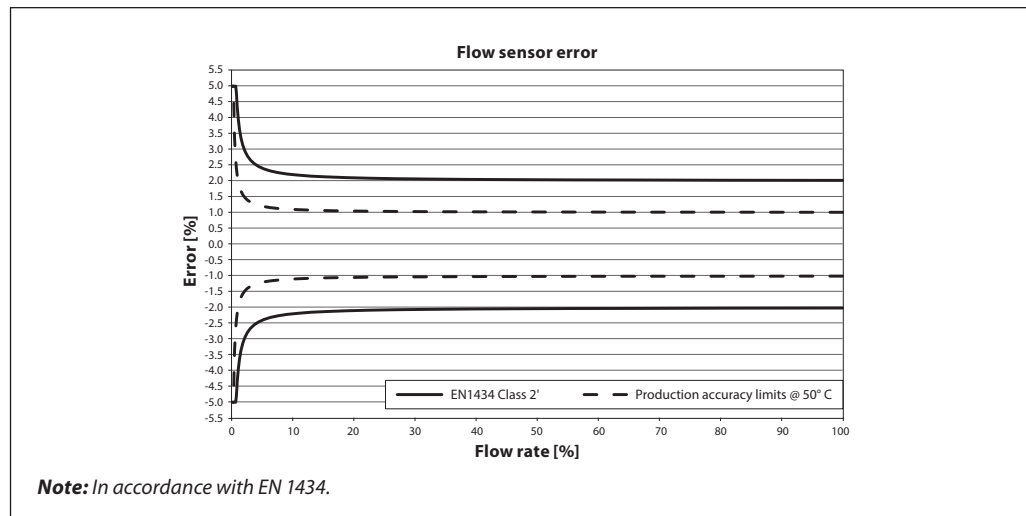

Pressure loss

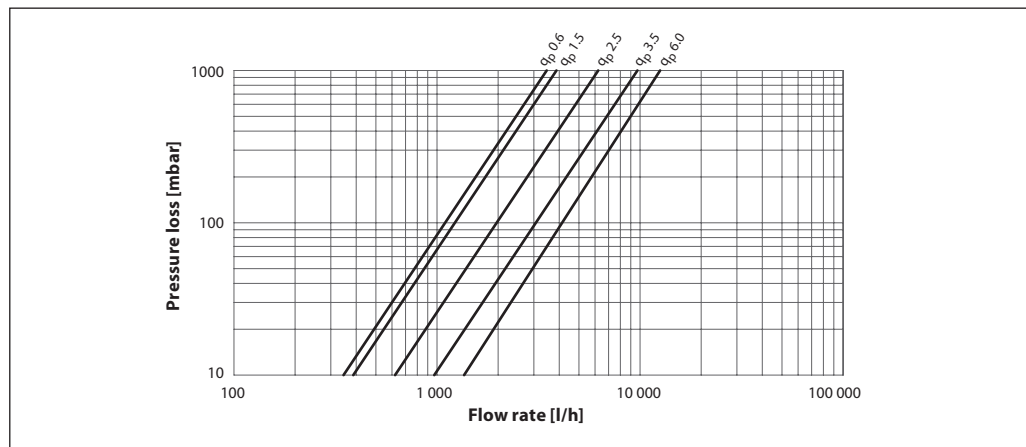

Menu structure

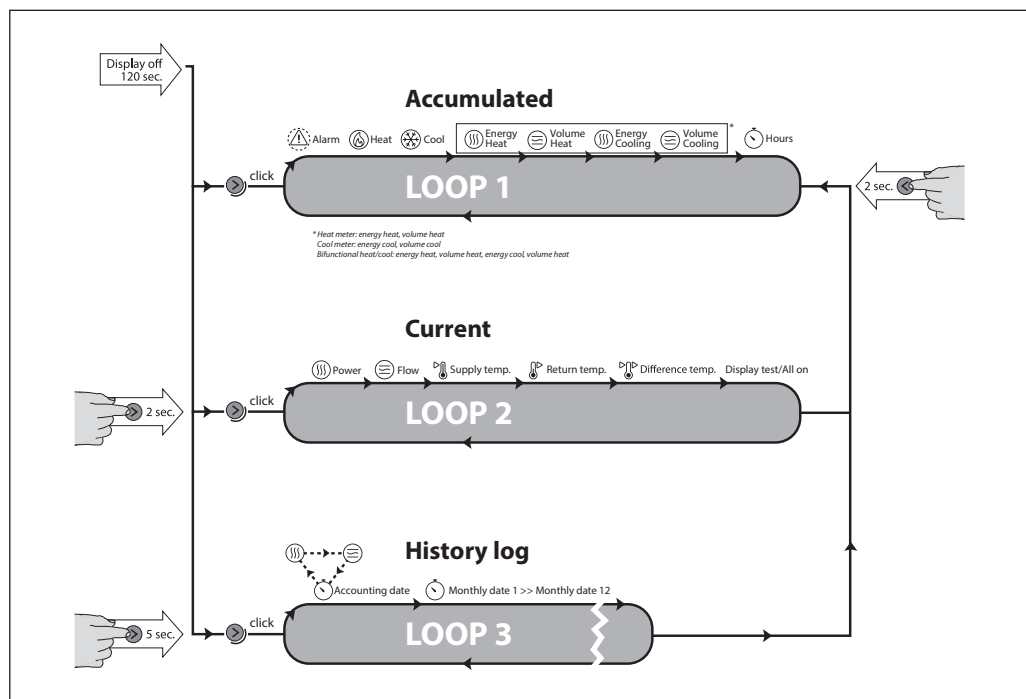

Mounting

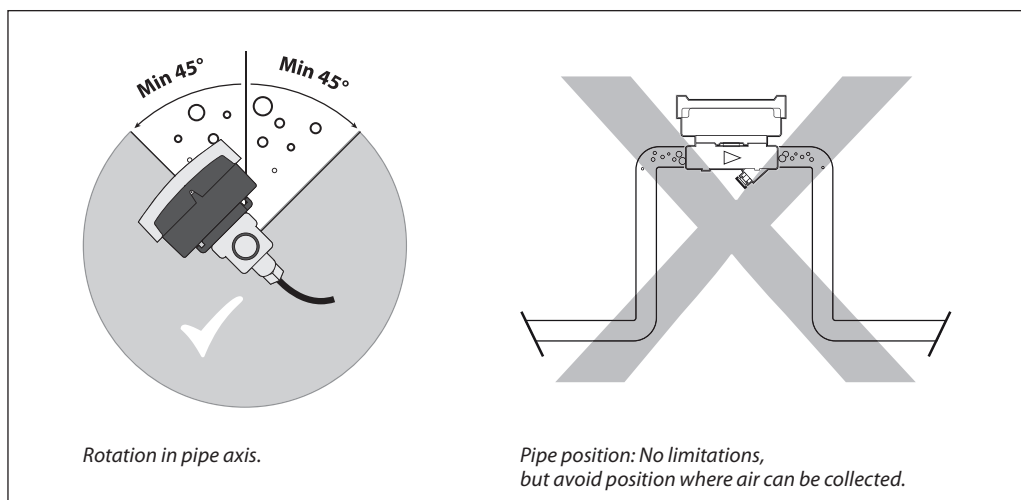

Dimensions

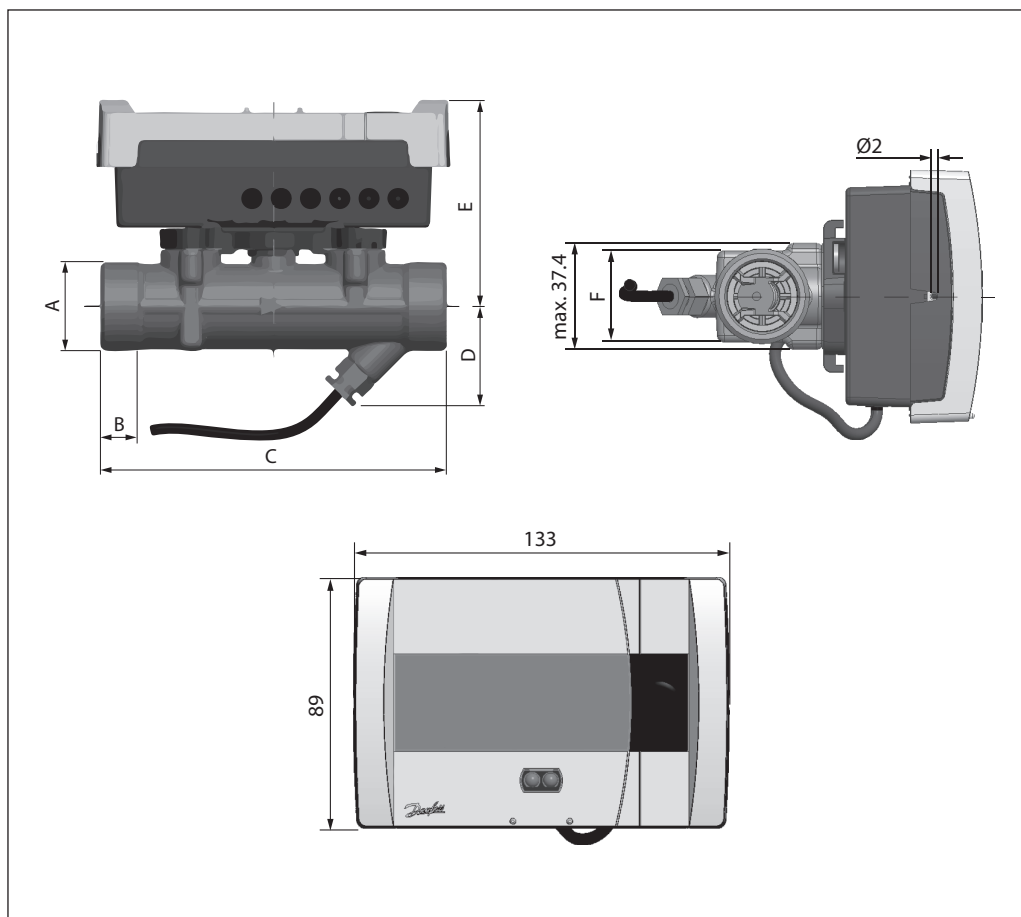

Dimension	DN15	DN20	DN20 + extension pipe 014U1957	DN25	DN25	DN32
A	G $\frac{3}{4}$ A	G1A	G1A	G1 $\frac{1}{4}$ A	G1 $\frac{1}{4}$ A	G1 $\frac{1}{2}$ A
B	12 mm	14 mm	14 mm	16 mm	16 mm	18 mm
C	110 mm	130 mm	190 mm	160 mm	260 mm	260 mm
D	33.5 mm	38 mm	38 mm	40.5 mm	40.5 mm	40.5 mm
E	74.5 mm	77.5 mm	77.5 mm	80.5 mm	80.5 mm	80.5 mm
F	32 mm	32 mm	32 mm	41 mm	41 mm	41 mm
Weight	700 g	800 g	1100 g	1100 g	1500 g	1600 g

**Ordering**  
**SonoSelect 10 - Heating**

Meter size	Installation	Cable length	Power supply	Integrated communication	Modules	Energy unit	Code No.
DN15 qp0.6m <sup>3</sup> /h G <sub>3/4</sub> 110mm	Return	PUR 1.5m	230V AC	None	Radio OMS 868,95 with 2 pulse inputs	kWh	014U0338
DN15 qp0.6m <sup>3</sup> /h G <sub>3/4</sub> 110mm	Supply	PUR 1.5m	230V AC	None	Radio OMS 868,95 with 2 pulse inputs	kWh	014U0339
DN15 qp0.6m <sup>3</sup> /h G <sub>3/4</sub> 110mm	Return	PUR 1.5m	230V AC	Wired M-Bus	No module	kWh	014U0449
DN15 qp0.6m <sup>3</sup> /h G <sub>3/4</sub> 110mm	Supply	PUR 1.5m	230V AC	Wired M-Bus	No module	kWh	014U0450
DN15 qp0.6m <sup>3</sup> /h G <sub>3/4</sub> 110mm	Return	PUR 1.5m	3.6V DC	None	Radio OMS 868,95 with 2 pulse inputs	kWh	014U0068
DN15 qp0.6m <sup>3</sup> /h G <sub>3/4</sub> 110mm	Return	PUR 1.5m	3.6V DC	None	Radio OMS 868,95 with 2 pulse inputs	GJ	014U0071
DN15 qp0.6m <sup>3</sup> /h G <sub>3/4</sub> 110mm	Supply	PUR 1.5m	3.6V DC	None	Radio OMS 868,95 with 2 pulse inputs	kWh	014U0069
DN15 qp0.6m <sup>3</sup> /h G <sub>3/4</sub> 110mm	Supply	PUR 1.5m	3.6V DC	None	Radio OMS 868,95 with 2 pulse inputs	GJ	014U0070
DN15 qp0.6m <sup>3</sup> /h G <sub>3/4</sub> 110mm	Return	PUR 1.5m	3.6V DC	None	Radio OMS WB 868,95 with 2 pulse inputs	kWh	014U0324
DN15 qp0.6m <sup>3</sup> /h G <sub>3/4</sub> 110mm	Return	PUR 1.5m	3.6V DC	None	Wired M-Bus with 2 pulse inputs	kWh	014U0072
DN15 qp0.6m <sup>3</sup> /h G <sub>3/4</sub> 110mm	Supply	PUR 1.5m	3.6V DC	None	Wired M-Bus with 2 pulse inputs	kWh	014U0073
DN15 qp0.6m <sup>3</sup> /h G <sub>3/4</sub> 110mm	Return	PUR 1.5m	3.6V DC	Wired M-Bus	2 pulse inputs	kWh	014U0183
DN15 qp0.6m <sup>3</sup> /h G <sub>3/4</sub> 110mm	Supply	PUR 1.5m	3.6V DC	Wired M-Bus	2 pulse inputs	kWh	014U0184
DN15 qp0.6m <sup>3</sup> /h G <sub>3/4</sub> 110mm	Return	PUR 1.5m	3.6V DC	Wired M-Bus	No module	kWh	014U0165
DN15 qp0.6m <sup>3</sup> /h G <sub>3/4</sub> 110mm	Supply	PUR 1.5m	3.6V DC	Wired M-Bus	No module	kWh	014U0166
DN15 qp1.5m <sup>3</sup> /h G <sub>3/4</sub> 110mm	Return	PUR 1.5m	230V AC	None	Radio OMS 868,95 with 2 pulse inputs	kWh	014U0340
DN15 qp1.5m <sup>3</sup> /h G <sub>3/4</sub> 110mm	Supply	PUR 1.5m	230V AC	None	Radio OMS 868,95 with 2 pulse inputs	kWh	014U0341
DN15 qp1.5m <sup>3</sup> /h G <sub>3/4</sub> 110mm	Return	PUR 1.5m	230V AC	Wired M-Bus	No module	kWh	014U0451
DN15 qp1.5m <sup>3</sup> /h G <sub>3/4</sub> 110mm	Supply	PUR 1.5m	230V AC	Wired M-Bus	No module	kWh	014U0452
DN15 qp1.5m <sup>3</sup> /h G <sub>3/4</sub> 110mm	Return	PUR 1.5m	230V AC	Wired M-Bus	Wired M-Bus with 2 pulse inputs	kWh	014U0350
DN15 qp1.5m <sup>3</sup> /h G <sub>3/4</sub> 110mm	Return	PUR 1.5m	3.6V DC	None	Radio OMS 868,95 with 2 pulse inputs	kWh	014U0081
DN15 qp1.5m <sup>3</sup> /h G <sub>3/4</sub> 110mm	Return	PUR 1.5m	3.6V DC	None	Radio OMS 868,95 with 2 pulse inputs	GJ	014U0084
DN15 qp1.5m <sup>3</sup> /h G <sub>3/4</sub> 110mm	Supply	PUR 1.5m	3.6V DC	None	Radio OMS 868,95 with 2 pulse inputs	kWh	014U0082
DN15 qp1.5m <sup>3</sup> /h G <sub>3/4</sub> 110mm	Supply	PUR 1.5m	3.6V DC	None	Radio OMS 868,95 with 2 pulse inputs	GJ	014U0083
DN15 qp1.5m <sup>3</sup> /h G <sub>3/4</sub> 110mm	Return	PUR 1.5m	3.6V DC	None	Radio OMS WB 868,95 with 2 pulse inputs	kWh	014U0253
DN15 qp1.5m <sup>3</sup> /h G <sub>3/4</sub> 110mm	Return	PUR 3.0m	3.6V DC	None	Radio OMS WB 868,95 with 2 pulse inputs	kWh	014U0326
DN15 qp1.5m <sup>3</sup> /h G <sub>3/4</sub> 110mm	Return	PUR 1.5m	3.6V DC	None	Wired M-Bus with 2 pulse inputs	kWh	014U0085
DN15 qp1.5m <sup>3</sup> /h G <sub>3/4</sub> 110mm	Supply	PUR 1.5m	3.6V DC	None	Wired M-Bus with 2 pulse inputs	kWh	014U0086
DN15 qp1.5m <sup>3</sup> /h G <sub>3/4</sub> 110mm	Return	PUR 1.5m	3.6V DC	Wired M-Bus	2 pulse inputs	kWh	014U0185
DN15 qp1.5m <sup>3</sup> /h G <sub>3/4</sub> 110mm	Supply	PUR 1.5m	3.6V DC	Wired M-Bus	2 pulse inputs	kWh	014U0186
DN15 qp1.5m <sup>3</sup> /h G <sub>3/4</sub> 110mm	Return	PUR 1.5m	3.6V DC	Wired M-Bus	No module	kWh	014U0167
DN15 qp1.5m <sup>3</sup> /h G <sub>3/4</sub> 110mm	Supply	PUR 1.5m	3.6V DC	Wired M-Bus	No module	kWh	014U0168
DN15 qp1.5m <sup>3</sup> /h G <sub>3/4</sub> 110mm	Return	PUR 1.5m	3.6V DC	Wired M-Bus	Wired M-Bus with 2 pulse inputs	kWh	014U0247
DN20 qp1.5m <sup>3</sup> /h G1 130mm	Return	PUR 1.5m	230V AC	None	Radio OMS 868,95 with 2 pulse inputs	kWh	014U0342
DN20 qp1.5m <sup>3</sup> /h G1 130mm	Supply	PUR 1.5m	230V AC	None	Radio OMS 868,95 with 2 pulse inputs	kWh	014U0343
DN20 qp1.5m <sup>3</sup> /h G1 130mm	Return	PUR 1.5m	230V AC	Wired M-Bus	No module	kWh	014U0453
DN20 qp1.5m <sup>3</sup> /h G1 130mm	Supply	PUR 1.5m	230V AC	Wired M-Bus	No module	kWh	014U0454
DN20 qp1.5m <sup>3</sup> /h G1 130mm	Return	PUR 1.5m	230V AC	Wired M-Bus	Wired M-Bus with 2 pulse inputs	kWh	014U0351
DN20 qp1.5m <sup>3</sup> /h G1 130mm	Return	PUR 1.5m	3.6V DC	None	Radio OMS 868,95 with 2 pulse inputs	kWh	014U0094
DN20 qp1.5m <sup>3</sup> /h G1 130mm	Return	PUR 1.5m	3.6V DC	None	Radio OMS 868,95 with 2 pulse inputs	GJ	014U0097
DN20 qp1.5m <sup>3</sup> /h G1 130mm	Supply	PUR 1.5m	3.6V DC	None	Radio OMS 868,95 with 2 pulse inputs	kWh	014U0095
DN20 qp1.5m <sup>3</sup> /h G1 130mm	Supply	PUR 1.5m	3.6V DC	None	Radio OMS 868,95 with 2 pulse inputs	GJ	014U0096
DN20 qp1.5m <sup>3</sup> /h G1 130mm	Return	PUR 1.5m	3.6V DC	None	Wired M-Bus with 2 pulse inputs	kWh	014U0098
DN20 qp1.5m <sup>3</sup> /h G1 130mm	Supply	PUR 1.5m	3.6V DC	None	Wired M-Bus with 2 pulse inputs	kWh	014U0099
DN20 qp1.5m <sup>3</sup> /h G1 130mm	Return	PUR 1.5m	3.6V DC	Wired M-Bus	2 pulse inputs	kWh	014U0187
DN20 qp1.5m <sup>3</sup> /h G1 130mm	Supply	PUR 1.5m	3.6V DC	Wired M-Bus	2 pulse inputs	kWh	014U0188
DN20 qp1.5m <sup>3</sup> /h G1 130mm	Return	PUR 1.5m	3.6V DC	Wired M-Bus	No module	kWh	014U0169
DN20 qp1.5m <sup>3</sup> /h G1 130mm	Supply	PUR 1.5m	3.6V DC	Wired M-Bus	No module	kWh	014U0170
DN20 qp1.5m <sup>3</sup> /h G1 130mm	Return	PUR 1.5m	3.6V DC	Wired M-Bus	Wired M-Bus with 2 pulse inputs	kWh	014U0248
DN20 qp2.5m <sup>3</sup> /h G1 130mm	Return	PUR 1.5m	230V AC	None	Radio OMS 868,95 with 2 pulse inputs	kWh	014U0344
DN20 qp2.5m <sup>3</sup> /h G1 130mm	Supply	PUR 1.5m	230V AC	None	Radio OMS 868,95 with 2 pulse inputs	kWh	014U0345
DN20 qp2.5m <sup>3</sup> /h G1 130mm	Return	PUR 1.5m	230V AC	Wired M-Bus	No module	kWh	014U0455
DN20 qp2.5m <sup>3</sup> /h G1 130mm	Supply	PUR 1.5m	230V AC	Wired M-Bus	No module	kWh	014U0456
DN20 qp2.5m <sup>3</sup> /h G1 130mm	Return	PUR 1.5m	230V AC	Wired M-Bus	Wired M-Bus with 2 pulse inputs	kWh	014U0352
DN20 qp2.5m <sup>3</sup> /h G1 130mm	Return	PUR 1.5m	3.6V DC	None	Radio OMS 868,95 with 2 pulse inputs	kWh	014U0107
DN20 qp2.5m <sup>3</sup> /h G1 130mm	Return	PUR 1.5m	3.6V DC	None	Radio OMS 868,95 with 2 pulse inputs	GJ	014U0110
DN20 qp2.5m <sup>3</sup> /h G1 130mm	Supply	PUR 1.5m	3.6V DC	None	Radio OMS 868,95 with 2 pulse inputs	kWh	014U0108
DN20 qp2.5m <sup>3</sup> /h G1 130mm	Supply	PUR 1.5m	3.6V DC	None	Radio OMS 868,95 with 2 pulse inputs	GJ	014U0109
DN20 qp2.5m <sup>3</sup> /h G1 130mm	Return	PUR 1.5m	3.6V DC	None	Radio OMS WB 868,95 with 2 pulse inputs	kWh	014U0325
DN20 qp2.5m <sup>3</sup> /h G1 130mm	Return	PUR 3.0m	3.6V DC	None	Radio OMS WB 868,95 with 2 pulse inputs	kWh	014U0327



**Ordering**  
**SonoSelect 10 - Heating**  
*(continuous)*

Meter size	Installation	Cable length	Power supply	Integrated communication	Modules	Energy unit	Code No.
DN20 qp2.5m <sup>3</sup> /h G1 130mm	Return	PUR 1.5m	3.6V DC	None	Wired M-Bus with 2 pulse inputs	kWh	014U0111
DN20 qp2.5m <sup>3</sup> /h G1 130mm	Supply	PUR 1.5m	3.6V DC	None	Wired M-Bus with 2 pulse inputs	kWh	014U0112
DN20 qp2.5m <sup>3</sup> /h G1 130mm	Return	PUR 1.5m	3.6V DC	Wired M-Bus	2 pulse inputs	kWh	014U0189
DN20 qp2.5m <sup>3</sup> /h G1 130mm	Supply	PUR 1.5m	3.6V DC	Wired M-Bus	2 pulse inputs	kWh	014U0190
DN20 qp2.5m <sup>3</sup> /h G1 130mm	Return	PUR 1.5m	3.6V DC	Wired M-Bus	No module	kWh	014U0171
DN20 qp2.5m <sup>3</sup> /h G1 130mm	Supply	PUR 1.5m	3.6V DC	Wired M-Bus	No module	kWh	014U0172
DN20 qp2.5m <sup>3</sup> /h G1 130mm	Return	PUR 1.5m	3.6V DC	Wired M-Bus	Wired M-Bus with 2 pulse inputs	kWh	014U0249
DN25 qp3.5m <sup>3</sup> /h G1¼ 160mm	Return	PUR 1.5m	230V AC	Wired M-Bus	No module	kWh	014U0457
DN25 qp3.5m <sup>3</sup> /h G1¼ 160mm	Supply	PUR 1.5m	230V AC	Wired M-Bus	No module	kWh	014U0458
DN25 qp3.5m <sup>3</sup> /h G1¼ 160mm	Return	PUR 1.5m	3.6V DC	None	Radio OMS 868,95 with 2 pulse inputs	kWh	014U0120
DN25 qp3.5m <sup>3</sup> /h G1¼ 160mm	Return	PUR 1.5m	3.6V DC	None	Radio OMS 868,95 with 2 pulse inputs	GJ	014U0123
DN25 qp3.5m <sup>3</sup> /h G1¼ 160mm	Supply	PUR 1.5m	3.6V DC	None	Radio OMS 868,95 with 2 pulse inputs	kWh	014U0121
DN25 qp3.5m <sup>3</sup> /h G1¼ 160mm	Supply	PUR 1.5m	3.6V DC	None	Radio OMS 868,95 with 2 pulse inputs	GJ	014U0122
DN25 qp3.5m <sup>3</sup> /h G1¼ 160mm	Return	PUR 1.5m	3.6V DC	None	Radio OMS WB 868,95 with 2 pulse inputs	kWh	014U0335
DN25 qp3.5m <sup>3</sup> /h G1¼ 160mm	Return	PUR 1.5m	3.6V DC	None	Wired M-Bus with 2 pulse inputs	kWh	014U0124
DN25 qp3.5m <sup>3</sup> /h G1¼ 160mm	Supply	PUR 1.5m	3.6V DC	None	Wired M-Bus with 2 pulse inputs	kWh	014U0125
DN25 qp3.5m <sup>3</sup> /h G1¼ 160mm	Return	PUR 1.5m	3.6V DC	Wired M-Bus	2 pulse inputs	kWh	014U0191
DN25 qp3.5m <sup>3</sup> /h G1¼ 160mm	Supply	PUR 1.5m	3.6V DC	Wired M-Bus	2 pulse inputs	kWh	014U0192
DN25 qp3.5m <sup>3</sup> /h G1¼ 160mm	Return	PUR 1.5m	3.6V DC	Wired M-Bus	No module	kWh	014U0173
DN25 qp3.5m <sup>3</sup> /h G1¼ 160mm	Supply	PUR 1.5m	3.6V DC	Wired M-Bus	No module	kWh	014U0174
DN25 qp3.5m <sup>3</sup> /h G1¼ 260mm	Return	PUR 1.5m	230V AC	None	Radio OMS 868,95 with 2 pulse inputs	kWh	014U0346
DN25 qp3.5m <sup>3</sup> /h G1¼ 260mm	Supply	PUR 1.5m	230V AC	None	Radio OMS 868,95 with 2 pulse inputs	kWh	014U0347
DN25 qp3.5m <sup>3</sup> /h G1¼ 260mm	Return	PUR 1.5m	230V AC	Wired M-Bus	No module	kWh	014U0459
DN25 qp3.5m <sup>3</sup> /h G1¼ 260mm	Supply	PUR 1.5m	230V AC	Wired M-Bus	No module	kWh	014U0460
DN25 qp3.5m <sup>3</sup> /h G1¼ 260mm	Return	PUR 1.5m	3.6V DC	None	Radio OMS 868,95 with 2 pulse inputs	kWh	014U0133
DN25 qp3.5m <sup>3</sup> /h G1¼ 260mm	Return	PUR 1.5m	3.6V DC	None	Radio OMS 868,95 with 2 pulse inputs	GJ	014U0136
DN25 qp3.5m <sup>3</sup> /h G1¼ 260mm	Supply	PUR 1.5m	3.6V DC	None	Radio OMS 868,95 with 2 pulse inputs	kWh	014U0134
DN25 qp3.5m <sup>3</sup> /h G1¼ 260mm	Supply	PUR 1.5m	3.6V DC	None	Radio OMS 868,95 with 2 pulse inputs	GJ	014U0135
DN25 qp3.5m <sup>3</sup> /h G1¼ 260mm	Return	PUR 1.5m	3.6V DC	None	Wired M-Bus with 2 pulse inputs	kWh	014U0137
DN25 qp3.5m <sup>3</sup> /h G1¼ 260mm	Supply	PUR 1.5m	3.6V DC	None	Wired M-Bus with 2 pulse inputs	kWh	014U0138
DN25 qp3.5m <sup>3</sup> /h G1¼ 260mm	Return	PUR 1.5m	3.6V DC	Wired M-Bus	No module	kWh	014U0447
DN25 qp3.5m <sup>3</sup> /h G1¼ 260mm	Supply	PUR 1.5m	3.6V DC	Wired M-Bus	No module	kWh	014U0448
DN25 qp6.0m <sup>3</sup> /h G1¼ 260mm	Return	PUR 1.5m	230V AC	None	Radio OMS 868,95 with 2 pulse inputs	kWh	014U0348
DN25 qp6.0m <sup>3</sup> /h G1¼ 260mm	Supply	PUR 1.5m	230V AC	None	Radio OMS 868,95 with 2 pulse inputs	kWh	014U0349
DN25 qp6.0m <sup>3</sup> /h G1¼ 260mm	Return	PUR 1.5m	230V AC	Wired M-Bus	No module	kWh	014U0461
DN25 qp6.0m <sup>3</sup> /h G1¼ 260mm	Supply	PUR 1.5m	230V AC	Wired M-Bus	No module	kWh	014U0462
DN25 qp6.0m <sup>3</sup> /h G1¼ 260mm	Return	PUR 1.5m	3.6V DC	None	Radio OMS 868,95 with 2 pulse inputs	kWh	014U0268
DN25 qp6.0m <sup>3</sup> /h G1¼ 260mm	Supply	PUR 1.5m	3.6V DC	None	Radio OMS 868,95 with 2 pulse inputs	kWh	014U0269
DN25 qp6.0m <sup>3</sup> /h G1¼ 260mm	Return	PUR 3.0m	3.6V DC	None	Radio OMS WB 868,95 with 2 pulse inputs	kWh	014U0328
DN25 qp6.0m <sup>3</sup> /h G1¼ 260mm	Return	PUR 1.5m	3.6V DC	None	Radio OMS WB 868,95 with 2 pulse inputs	kWh	014U0336
DN25 qp6.0m <sup>3</sup> /h G1¼ 260mm	Return	PUR 1.5m	3.6V DC	Wired M-Bus	2 pulse inputs	kWh	014U0270
DN25 qp6.0m <sup>3</sup> /h G1¼ 260mm	Supply	PUR 1.5m	3.6V DC	Wired M-Bus	2 pulse inputs	kWh	014U0271
DN25 qp6.0m <sup>3</sup> /h G1¼ 260mm	Return	PUR 1.5m	3.6V DC	Wired M-Bus	No module	kWh	014U0272
DN25 qp6.0m <sup>3</sup> /h G1¼ 260mm	Supply	PUR 1.5m	3.6V DC	Wired M-Bus	No module	kWh	014U0273
DN32 qp6.0m <sup>3</sup> /h G1½ 260mm	Return	PUR 1.5m	230V AC	Wired M-Bus	No module	kWh	014U0463
DN32 qp6.0m <sup>3</sup> /h G1½ 260mm	Supply	PUR 1.5m	230V AC	Wired M-Bus	No module	kWh	014U0464
DN32 qp6.0m <sup>3</sup> /h G1½ 260mm	Return	PUR 1.5m	3.6V DC	None	Radio OMS 868,95 with 2 pulse inputs	kWh	014U0278
DN32 qp6.0m <sup>3</sup> /h G1½ 260mm	Supply	PUR 1.5m	3.6V DC	None	Radio OMS 868,95 with 2 pulse inputs	kWh	014U0279
DN32 qp6.0m <sup>3</sup> /h G1½ 260mm	Return	PUR 1.5m	3.6V DC	None	Radio OMS WB 868,95 with 2 pulse inputs	kWh	014U0337
DN32 qp6.0m <sup>3</sup> /h G1½ 260mm	Return	PUR 1.5m	3.6V DC	Wired M-Bus	2 pulse inputs	kWh	014U0280
DN32 qp6.0m <sup>3</sup> /h G1½ 260mm	Supply	PUR 1.5m	3.6V DC	Wired M-Bus	2 pulse inputs	kWh	014U0281
DN32 qp6.0m <sup>3</sup> /h G1½ 260mm	Return	PUR 1.5m	3.6V DC	Wired M-Bus	No module	kWh	014U0282
DN32 qp6.0m <sup>3</sup> /h G1½ 260mm	Supply	PUR 1.5m	3.6V DC	Wired M-Bus	No module	kWh	014U0283

**Ordering**  
**SonoSafe 10 - Heating**

Meter size	Installation	Cable length	Power supply	Integrated communication	Modules	Energy unit	Code No.
DN32 qp6.0m <sup>3</sup> /h G1½ 260mm	Return	PVC 1.5m	3.6V DC	None	No module	kWh	014U0274
DN32 qp6.0m <sup>3</sup> /h G1½ 260mm	Supply	PVC 1.5m	3.6V DC	None	No module	kWh	014U0275
DN32 qp6.0m <sup>3</sup> /h G1½ 260mm	Return	PVC 1.5m	3.6V DC	None	Radio OMS WB 868,95 with 2 pulse inputs	kWh	014U0334
DN32 qp6.0m <sup>3</sup> /h G1½ 260mm	Return	PVC 1.5m	3.6V DC	Wired M-Bus	No module	kWh	014U0276
DN32 qp6.0m <sup>3</sup> /h G1½ 260mm	Supply	PVC 1.5m	3.6V DC	Wired M-Bus	No module	kWh	014U0277
DN25 qp6.0m <sup>3</sup> /h G1¼ 260mm	Return	PVC 1.5m	230V AC	Wired M-Bus	No module	kWh	014U0371
DN25 qp6.0m <sup>3</sup> /h G1¼ 260mm	Supply	PVC 1.5m	230V AC	Wired M-Bus	No module	kWh	014U0372
DN25 qp6.0m <sup>3</sup> /h G1¼ 260mm	Return	PVC 1.5m	3.6V DC	None	No module	kWh	014U0264
DN25 qp6.0m <sup>3</sup> /h G1¼ 260mm	Supply	PVC 1.5m	3.6V DC	None	No module	kWh	014U0265
DN25 qp6.0m <sup>3</sup> /h G1¼ 260mm	Return	PVC 1.5m	3.6V DC	None	Radio OMS WB 868,95 with 2 pulse inputs	kWh	014U0333
DN25 qp6.0m <sup>3</sup> /h G1¼ 260mm	Return	PVC 1.5m	3.6V DC	Wired M-Bus	No module	kWh	014U0266
DN25 qp6.0m <sup>3</sup> /h G1¼ 260mm	Supply	PVC 1.5m	3.6V DC	Wired M-Bus	No module	kWh	014U0267
DN25 qp3.5m <sup>3</sup> /h G1¼ 260mm	Return	PVC 1.5m	230V AC	Wired M-Bus	No module	kWh	014U0369
DN25 qp3.5m <sup>3</sup> /h G1¼ 260mm	Supply	PVC 1.5m	230V AC	Wired M-Bus	No module	kWh	014U0370
DN25 qp3.5m <sup>3</sup> /h G1¼ 260mm	Return	PVC 1.5m	3.6V DC	None	No module	GJ	014U0062
DN25 qp3.5m <sup>3</sup> /h G1¼ 260mm	Return	PVC 1.5m	3.6V DC	None	No module	kWh	014U0021
DN25 qp3.5m <sup>3</sup> /h G1¼ 260mm	Supply	PVC 1.5m	3.6V DC	None	No module	GJ	014U0061
DN25 qp3.5m <sup>3</sup> /h G1¼ 260mm	Supply	PVC 1.5m	3.6V DC	None	No module	kWh	014U0022
DN25 qp3.5m <sup>3</sup> /h G1¼ 260mm	Return	PVC 1.5m	3.6V DC	None	Radio OMS 868,95 with 2 pulse inputs	kWh	014U0245
DN25 qp3.5m <sup>3</sup> /h G1¼ 260mm	Supply	PVC 1.5m	3.6V DC	None	Radio OMS 868,95 with 2 pulse inputs	kWh	014U0246
DN25 qp3.5m <sup>3</sup> /h G1¼ 260mm	Return	PVC 1.5m	3.6V DC	Wired M-Bus	No module	GJ	014U0064
DN25 qp3.5m <sup>3</sup> /h G1¼ 260mm	Return	PVC 1.5m	3.6V DC	Wired M-Bus	No module	kWh	014U0023
DN25 qp3.5m <sup>3</sup> /h G1¼ 260mm	Supply	PVC 1.5m	3.6V DC	Wired M-Bus	No module	GJ	014U0063
DN25 qp3.5m <sup>3</sup> /h G1¼ 260mm	Supply	PVC 1.5m	3.6V DC	Wired M-Bus	No module	kWh	014U0024
DN25 qp3.5m <sup>3</sup> /h G1¼ 160mm	Return	PVC 1.5m	3.6V DC	None	No module	GJ	014U0055
DN25 qp3.5m <sup>3</sup> /h G1¼ 160mm	Return	PVC 1.5m	3.6V DC	None	No module	kWh	014U0017
DN25 qp3.5m <sup>3</sup> /h G1¼ 160mm	Supply	PVC 1.5m	3.6V DC	None	No module	GJ	014U0054
DN25 qp3.5m <sup>3</sup> /h G1¼ 160mm	Supply	PVC 1.5m	3.6V DC	None	No module	kWh	014U0018
DN25 qp3.5m <sup>3</sup> /h G1¼ 160mm	Return	PVC 1.5m	3.6V DC	None	Radio OMS 868,95 with 2 pulse inputs	kWh	014U0243
DN25 qp3.5m <sup>3</sup> /h G1¼ 160mm	Supply	PVC 1.5m	3.6V DC	None	Radio OMS 868,95 with 2 pulse inputs	kWh	014U0244
DN25 qp3.5m <sup>3</sup> /h G1¼ 160mm	Return	PVC 1.5m	3.6V DC	None	Radio OMS WB 868,95 with 2 pulse inputs	kWh	014U0332
DN25 qp3.5m <sup>3</sup> /h G1¼ 160mm	Return	PVC 1.5m	3.6V DC	Wired M-Bus	2 pulse inputs	kWh	014U0211
DN25 qp3.5m <sup>3</sup> /h G1¼ 160mm	Supply	PVC 1.5m	3.6V DC	Wired M-Bus	2 pulse inputs	kWh	014U0212
DN25 qp3.5m <sup>3</sup> /h G1¼ 160mm	Return	PVC 1.5m	3.6V DC	Wired M-Bus	No module	GJ	014U0057
DN25 qp3.5m <sup>3</sup> /h G1¼ 160mm	Return	PVC 1.5m	3.6V DC	Wired M-Bus	No module	kWh	014U0019
DN25 qp3.5m <sup>3</sup> /h G1¼ 160mm	Supply	PVC 1.5m	3.6V DC	Wired M-Bus	No module	GJ	014U0056
DN25 qp3.5m <sup>3</sup> /h G1¼ 160mm	Supply	PVC 1.5m	3.6V DC	Wired M-Bus	No module	kWh	014U0020
DN20 qp2.5m <sup>3</sup> /h G1 130mm	Return	PVC 1.5m	230V AC	Wired M-Bus	No module	kWh	014U0367
DN20 qp2.5m <sup>3</sup> /h G1 130mm	Supply	PVC 1.5m	230V AC	Wired M-Bus	No module	kWh	014U0368
DN20 qp2.5m <sup>3</sup> /h G1 130mm	Return	PVC 1.5m	3.6V DC	None	No module	GJ	014U0048
DN20 qp2.5m <sup>3</sup> /h G1 130mm	Return	PVC 1.5m	3.6V DC	None	No module	kWh	014U0013
DN20 qp2.5m <sup>3</sup> /h G1 130mm	Supply	PVC 1.5m	3.6V DC	None	No module	GJ	014U0047
DN20 qp2.5m <sup>3</sup> /h G1 130mm	Supply	PVC 1.5m	3.6V DC	None	No module	kWh	014U0014
DN20 qp2.5m <sup>3</sup> /h G1 130mm	Return	PVC 1.5m	3.6V DC	None	Radio OMS 868,95 with 2 pulse inputs	kWh	014U0241
DN20 qp2.5m <sup>3</sup> /h G1 130mm	Supply	PVC 1.5m	3.6V DC	None	Radio OMS 868,95 with 2 pulse inputs	kWh	014U0242
DN20 qp2.5m <sup>3</sup> /h G1 130mm	Return	PVC 1.5m	3.6V DC	None	Radio OMS WB 868,95 with 2 pulse inputs	kWh	014U0252
DN20 qp2.5m <sup>3</sup> /h G1 130mm	Return	PVC 1.5m	3.6V DC	Wired M-Bus	2 pulse inputs	kWh	014U0209
DN20 qp2.5m <sup>3</sup> /h G1 130mm	Supply	PVC 1.5m	3.6V DC	Wired M-Bus	2 pulse inputs	kWh	014U0210
DN20 qp2.5m <sup>3</sup> /h G1 130mm	Return	PVC 1.5m	3.6V DC	Wired M-Bus	No module	GJ	014U0050
DN20 qp2.5m <sup>3</sup> /h G1 130mm	Return	PVC 1.5m	3.6V DC	Wired M-Bus	No module	kWh	014U0015
DN20 qp2.5m <sup>3</sup> /h G1 130mm	Supply	PVC 1.5m	3.6V DC	Wired M-Bus	No module	GJ	014U0049
DN20 qp2.5m <sup>3</sup> /h G1 130mm	Supply	PVC 1.5m	3.6V DC	Wired M-Bus	No module	kWh	014U0016
DN20 qp1.5m <sup>3</sup> /h G1 130mm	Return	PVC 1.5m	230V AC	Wired M-Bus	No module	kWh	014U0365
DN20 qp1.5m <sup>3</sup> /h G1 130mm	Supply	PVC 1.5m	230V AC	Wired M-Bus	No module	kWh	014U0366
DN20 qp1.5m <sup>3</sup> /h G1 130mm	Return	PVC 1.5m	3.6V DC	None	No module	GJ	014U0041
DN20 qp1.5m <sup>3</sup> /h G1 130mm	Return	PVC 1.5m	3.6V DC	None	No module	kWh	014U0009
DN20 qp1.5m <sup>3</sup> /h G1 130mm	Supply	PVC 1.5m	3.6V DC	None	No module	GJ	014U0040
DN20 qp1.5m <sup>3</sup> /h G1 130mm	Supply	PVC 1.5m	3.6V DC	None	No module	kWh	014U0010
DN20 qp1.5m <sup>3</sup> /h G1 130mm	Return	PVC 1.5m	3.6V DC	None	Radio OMS 868,95 with 2 pulse inputs	kWh	014U0239
DN20 qp1.5m <sup>3</sup> /h G1 130mm	Supply	PVC 1.5m	3.6V DC	None	Radio OMS 868,95 with 2 pulse inputs	kWh	014U0240

**Ordering**  
**SonoSafe 10 - Heating**  
*(continuous)*

Meter size	Installation	Cable length	Power supply	Integrated communication	Modules	Energy unit	Code No.
DN20 qp1.5m <sup>3</sup> /h G1 130mm	Return	PVC 1.5m	3.6V DC	Wired M-Bus	2 pulse inputs	kWh	014U0207
DN20 qp1.5m <sup>3</sup> /h G1 130mm	Supply	PVC 1.5m	3.6V DC	Wired M-Bus	2 pulse inputs	kWh	014U0208
DN20 qp1.5m <sup>3</sup> /h G1 130mm	Return	PVC 1.5m	3.6V DC	Wired M-Bus	No module	GJ	014U0043
DN20 qp1.5m <sup>3</sup> /h G1 130mm	Return	PVC 1.5m	3.6V DC	Wired M-Bus	No module	kWh	014U0011
DN20 qp1.5m <sup>3</sup> /h G1 130mm	Supply	PVC 1.5m	3.6V DC	Wired M-Bus	No module	GJ	014U0042
DN20 qp1.5m <sup>3</sup> /h G1 130mm	Supply	PVC 1.5m	3.6V DC	Wired M-Bus	No module	kWh	014U0012
DN15 qp1.5m <sup>3</sup> /h G¾ 110mm	Return	PVC 1.5m	230V AC	Wired M-Bus	No module	kWh	014U0363
DN15 qp1.5m <sup>3</sup> /h G¾ 110mm	Supply	PVC 1.5m	230V AC	Wired M-Bus	No module	kWh	014U0364
DN15 qp1.5m <sup>3</sup> /h G¾ 110mm	Return	PVC 1.5m	3.6V DC	None	No module	GJ	014U0034
DN15 qp1.5m <sup>3</sup> /h G¾ 110mm	Return	PVC 1.5m	3.6V DC	None	No module	kWh	014U0005
DN15 qp1.5m <sup>3</sup> /h G¾ 110mm	Supply	PVC 1.5m	3.6V DC	None	No module	GJ	014U0033
DN15 qp1.5m <sup>3</sup> /h G¾ 110mm	Supply	PVC 1.5m	3.6V DC	None	No module	kWh	014U0006
DN15 qp1.5m <sup>3</sup> /h G¾ 110mm	Return	PVC 1.5m	3.6V DC	None	Radio OMS 868,95 with 2 pulse inputs	kWh	014U0237
DN15 qp1.5m <sup>3</sup> /h G¾ 110mm	Supply	PVC 1.5m	3.6V DC	None	Radio OMS 868,95 with 2 pulse inputs	kWh	014U0238
DN15 qp1.5m <sup>3</sup> /h G¾ 110mm	Return	PVC 1.5m	3.6V DC	None	Radio OMS WB 868,95 with 2 pulse inputs	kWh	014U0251
DN15 qp1.5m <sup>3</sup> /h G¾ 110mm	Return	PVC 1.5m	3.6V DC	Wired M-Bus	2 pulse inputs	kWh	014U0205
DN15 qp1.5m <sup>3</sup> /h G¾ 110mm	Supply	PVC 1.5m	3.6V DC	Wired M-Bus	2 pulse inputs	kWh	014U0206
DN15 qp1.5m <sup>3</sup> /h G¾ 110mm	Return	PVC 1.5m	3.6V DC	Wired M-Bus	No module	GJ	014U0036
DN15 qp1.5m <sup>3</sup> /h G¾ 110mm	Return	PVC 1.5m	3.6V DC	Wired M-Bus	No module	kWh	014U0007
DN15 qp1.5m <sup>3</sup> /h G¾ 110mm	Supply	PVC 1.5m	3.6V DC	Wired M-Bus	No module	GJ	014U0035
DN15 qp1.5m <sup>3</sup> /h G¾ 110mm	Supply	PVC 1.5m	3.6V DC	Wired M-Bus	No module	kWh	014U0008
DN15 qp0.6m <sup>3</sup> /h G¾ 110mm	Return	PVC 1.5m	230V AC	Wired M-Bus	No module	kWh	014U0361
DN15 qp0.6m <sup>3</sup> /h G¾ 110mm	Supply	PVC 1.5m	230V AC	Wired M-Bus	No module	kWh	014U0362
DN15 qp0.6m <sup>3</sup> /h G¾ 110mm	Return	PVC 1.5m	3.6V DC	None	No module	GJ	014U0027
DN15 qp0.6m <sup>3</sup> /h G¾ 110mm	Return	PVC 1.5m	3.6V DC	None	No module	kWh	014U0001
DN15 qp0.6m <sup>3</sup> /h G¾ 110mm	Supply	PVC 1.5m	3.6V DC	None	No module	GJ	014U0026
DN15 qp0.6m <sup>3</sup> /h G¾ 110mm	Supply	PVC 1.5m	3.6V DC	None	No module	kWh	014U0002
DN15 qp0.6m <sup>3</sup> /h G¾ 110mm	Return	PVC 1.5m	3.6V DC	None	Radio OMS 868,95 with 2 pulse inputs	kWh	014U0235
DN15 qp0.6m <sup>3</sup> /h G¾ 110mm	Supply	PVC 1.5m	3.6V DC	None	Radio OMS 868,95 with 2 pulse inputs	kWh	014U0236
DN15 qp0.6m <sup>3</sup> /h G¾ 110mm	Return	PVC 1.5m	3.6V DC	None	Radio OMS WB 868,95 with 2 pulse inputs	kWh	014U0250
DN15 qp0.6m <sup>3</sup> /h G¾ 110mm	Return	PVC 1.5m	3.6V DC	Wired M-Bus	2 pulse inputs	kWh	014U0203
DN15 qp0.6m <sup>3</sup> /h G¾ 110mm	Supply	PVC 1.5m	3.6V DC	Wired M-Bus	2 pulse inputs	kWh	014U0204
DN15 qp0.6m <sup>3</sup> /h G¾ 110mm	Return	PVC 1.5m	3.6V DC	Wired M-Bus	No module	GJ	014U0029
DN15 qp0.6m <sup>3</sup> /h G¾ 110mm	Return	PVC 1.5m	3.6V DC	Wired M-Bus	No module	kWh	014U0003
DN15 qp0.6m <sup>3</sup> /h G¾ 110mm	Supply	PVC 1.5m	3.6V DC	Wired M-Bus	No module	GJ	014U0028
DN15 qp0.6m <sup>3</sup> /h G¾ 110mm	Supply	PVC 1.5m	3.6V DC	Wired M-Bus	No module	kWh	014U0004

**Ordering**  
**SonoSelect 10 - Cooling**

Meter size	Installation	Cable length	Power supply	Integrated communication	Modules	Energy unit	Code No.
DN15 qp0.6m <sup>3</sup> /h G <sup>3</sup> / <sub>4</sub> 110mm	Return	PUR 1.5m	230V AC	None	Radio OMS 868,95 with 2 pulse inputs	kWh	014U1463
DN15 qp0.6m <sup>3</sup> /h G <sup>3</sup> / <sub>4</sub> 110mm	Return	PUR 1.5m	230V AC	Wired M-Bus	No module	kWh	014U1456
DN15 qp0.6m <sup>3</sup> /h G <sup>3</sup> / <sub>4</sub> 110mm	Return	PUR 1.5m	3.6V DC	None	Radio OMS 868,95 with 2 pulse inputs	kWh	014U1410
DN15 qp0.6m <sup>3</sup> /h G <sup>3</sup> / <sub>4</sub> 110mm	Return	PUR 1.5m	3.6V DC	None	Radio OMS WB 868,95 with 2 pulse inputs	kWh	014U1448
DN15 qp0.6m <sup>3</sup> /h G <sup>3</sup> / <sub>4</sub> 110mm	Return	PUR 1.5m	3.6V DC	Wired M-Bus	2 pulse inputs	kWh	014U1405
DN15 qp0.6m <sup>3</sup> /h G <sup>3</sup> / <sub>4</sub> 110mm	Return	PUR 1.5m	3.6V DC	Wired M-Bus	No module	kWh	014U1400
DN15 qp1.5m <sup>3</sup> /h G <sup>3</sup> / <sub>4</sub> 110mm	Return	PUR 1.5m	230V AC	None	Radio OMS 868,95 with 2 pulse inputs	kWh	014U1464
DN15 qp1.5m <sup>3</sup> /h G <sup>3</sup> / <sub>4</sub> 110mm	Return	PUR 1.5m	230V AC	Wired M-Bus	No module	kWh	014U1457
DN15 qp1.5m <sup>3</sup> /h G <sup>3</sup> / <sub>4</sub> 110mm	Return	PUR 1.5m	230V AC	Wired M-Bus	Wired M-Bus with 2 pulse inputs	kWh	014U1470
DN15 qp1.5m <sup>3</sup> /h G <sup>3</sup> / <sub>4</sub> 110mm	Return	PUR 1.5m	3.6V DC	None	Radio OMS 868,95 with 2 pulse inputs	kWh	014U1411
DN15 qp1.5m <sup>3</sup> /h G <sup>3</sup> / <sub>4</sub> 110mm	Return	PUR 3.0m	3.6V DC	None	Radio OMS WB 868,95 with 2 pulse inputs	kWh	014U1435
DN15 qp1.5m <sup>3</sup> /h G <sup>3</sup> / <sub>4</sub> 110mm	Return	PUR 1.5m	3.6V DC	None	Radio OMS WB 868,95 with 2 pulse inputs	kWh	014U1449
DN15 qp1.5m <sup>3</sup> /h G <sup>3</sup> / <sub>4</sub> 110mm	Return	PUR 1.5m	3.6V DC	Wired M-Bus	2 pulse inputs	kWh	014U1406
DN15 qp1.5m <sup>3</sup> /h G <sup>3</sup> / <sub>4</sub> 110mm	Return	PUR 1.5m	3.6V DC	Wired M-Bus	No module	kWh	014U1401
DN15 qp1.5m <sup>3</sup> /h G <sup>3</sup> / <sub>4</sub> 110mm	Return	PUR 1.5m	3.6V DC	Wired M-Bus	Wired M-Bus with 2 pulse inputs	kWh	014U1415
DN15 qp1.5m <sup>3</sup> /h G <sup>3</sup> / <sub>4</sub> 110mm	Return	PUR 3.0m	3.6V DC	Wired M-Bus	Wired M-Bus with 2 pulse inputs	kWh	014U1455
DN20 qp1.5m <sup>3</sup> /h G1 130mm	Return	PUR 1.5m	230V AC	None	Radio OMS 868,95 with 2 pulse inputs	kWh	014U1465
DN20 qp1.5m <sup>3</sup> /h G1 130mm	Return	PUR 1.5m	230V AC	Wired M-Bus	No module	kWh	014U1458
DN20 qp1.5m <sup>3</sup> /h G1 130mm	Return	PUR 1.5m	230V AC	Wired M-Bus	Wired M-Bus with 2 pulse inputs	kWh	014U1471
DN20 qp1.5m <sup>3</sup> /h G1 130mm	Return	PUR 1.5m	3.6V DC	None	Radio OMS 868,95 with 2 pulse inputs	kWh	014U1412
DN20 qp1.5m <sup>3</sup> /h G1 130mm	Return	PUR 1.5m	3.6V DC	None	Radio OMS WB 868,95 with 2 pulse inputs	kWh	014U1450
DN20 qp1.5m <sup>3</sup> /h G1 130mm	Return	PUR 1.5m	3.6V DC	Wired M-Bus	2 pulse inputs	kWh	014U1407
DN20 qp1.5m <sup>3</sup> /h G1 130mm	Return	PUR 1.5m	3.6V DC	Wired M-Bus	No module	kWh	014U1402
DN20 qp1.5m <sup>3</sup> /h G1 130mm	Return	PUR 1.5m	3.6V DC	Wired M-Bus	Wired M-Bus with 2 pulse inputs	kWh	014U1416
DN20 qp2.5m <sup>3</sup> /h G1 130mm	Return	PUR 1.5m	230V AC	None	Radio OMS 868,95 with 2 pulse inputs	kWh	014U1466
DN20 qp2.5m <sup>3</sup> /h G1 130mm	Return	PUR 1.5m	230V AC	Wired M-Bus	No module	kWh	014U1459
DN20 qp2.5m <sup>3</sup> /h G1 130mm	Return	PUR 1.5m	230V AC	Wired M-Bus	Wired M-Bus with 2 pulse inputs	kWh	014U1472
DN20 qp2.5m <sup>3</sup> /h G1 130mm	Return	PUR 1.5m	3.6V DC	None	Radio OMS 868,95 with 2 pulse inputs	kWh	014U1413
DN20 qp2.5m <sup>3</sup> /h G1 130mm	Return	PUR 3.0m	3.6V DC	None	Radio OMS WB 868,95 with 2 pulse inputs	kWh	014U1436
DN20 qp2.5m <sup>3</sup> /h G1 130mm	Return	PUR 1.5m	3.6V DC	None	Radio OMS WB 868,95 with 2 pulse inputs	kWh	014U1451
DN20 qp2.5m <sup>3</sup> /h G1 130mm	Return	PUR 1.5m	3.6V DC	Wired M-Bus	2 pulse inputs	kWh	014U1408
DN20 qp2.5m <sup>3</sup> /h G1 130mm	Return	PUR 1.5m	3.6V DC	Wired M-Bus	No module	kWh	014U1403
DN20 qp2.5m <sup>3</sup> /h G1 130mm	Return	PUR 1.5m	3.6V DC	Wired M-Bus	Wired M-Bus with 2 pulse inputs	kWh	014U1417
DN25 qp3.5m <sup>3</sup> /h G1¼ 160mm	Return	PUR 1.5m	230V AC	None	Radio OMS 868,95 with 2 pulse inputs	kWh	014U1467
DN25 qp3.5m <sup>3</sup> /h G1¼ 160mm	Return	PUR 1.5m	230V AC	Wired M-Bus	No module	kWh	014U1460
DN25 qp3.5m <sup>3</sup> /h G1¼ 160mm	Return	PUR 1.5m	3.6V DC	None	Radio OMS 868,95 with 2 pulse inputs	kWh	014U1414
DN25 qp3.5m <sup>3</sup> /h G1¼ 160mm	Return	PUR 1.5m	3.6V DC	None	Radio OMS WB 868,95 with 2 pulse inputs	kWh	014U1452
DN25 qp3.5m <sup>3</sup> /h G1¼ 160mm	Return	PUR 3.0m	3.6V DC	None	Radio OMS WB 868,95 with 2 pulse inputs	kWh	014U1453
DN25 qp3.5m <sup>3</sup> /h G1¼ 160mm	Return	PUR 1.5m	3.6V DC	Wired M-Bus	2 pulse inputs	kWh	014U1409
DN25 qp3.5m <sup>3</sup> /h G1¼ 160mm	Return	PUR 1.5m	3.6V DC	Wired M-Bus	No module	kWh	014U1404
DN25 qp3.5m <sup>3</sup> /h G1¼ 260mm	Return	PUR 1.5m	3.6V DC	None	Radio OMS 868,95 with 2 pulse inputs	kWh	014U1426
DN25 qp3.5m <sup>3</sup> /h G1¼ 260mm	Return	PUR 1.5m	3.6V DC	Wired M-Bus	2 pulse inputs	kWh	014U1425
DN25 qp3.5m <sup>3</sup> /h G1¼ 260mm	Return	PUR 1.5m	3.6V DC	Wired M-Bus	No module	kWh	014U1424
DN25 qp6.0m <sup>3</sup> /h G1¼ 260mm	Return	PUR 1.5m	230V AC	None	Radio OMS 868,95 with 2 pulse inputs	kWh	014U1468
DN25 qp6.0m <sup>3</sup> /h G1¼ 260mm	Return	PUR 1.5m	230V AC	Wired M-Bus	No module	kWh	014U1461
DN25 qp6.0m <sup>3</sup> /h G1¼ 260mm	Return	PUR 1.5m	3.6V DC	None	Radio OMS 868,95 with 2 pulse inputs	kWh	014U1431
DN25 qp6.0m <sup>3</sup> /h G1¼ 260mm	Return	PUR 3.0m	3.6V DC	None	Radio OMS WB 868,95 with 2 pulse inputs	kWh	014U1437
DN25 qp6.0m <sup>3</sup> /h G1¼ 260mm	Return	PUR 1.5m	3.6V DC	Wired M-Bus	2 pulse inputs	kWh	014U1430
DN25 qp6.0m <sup>3</sup> /h G1¼ 260mm	Return	PUR 1.5m	3.6V DC	Wired M-Bus	No module	kWh	014U1429
DN32 qp6.0m <sup>3</sup> /h G1½ 260mm	Return	PUR 1.5m	230V AC	None	Radio OMS 868,95 with 2 pulse inputs	kWh	014U1469
DN32 qp6.0m <sup>3</sup> /h G1½ 260mm	Return	PUR 1.5m	230V AC	Wired M-Bus	No module	kWh	014U1462
DN32 qp6.0m <sup>3</sup> /h G1½ 260mm	Return	PUR 1.5m	3.6V DC	None	Radio OMS 868,95 with 2 pulse inputs	kWh	014U1434
DN32 qp6.0m <sup>3</sup> /h G1½ 260mm	Return	PUR 3.0m	3.6V DC	None	Radio OMS WB 868,95 with 2 pulse inputs	kWh	014U1454
DN32 qp6.0m <sup>3</sup> /h G1½ 260mm	Return	PUR 1.5m	3.6V DC	Wired M-Bus	2 pulse inputs	kWh	014U1433
DN32 qp6.0m <sup>3</sup> /h G1½ 260mm	Return	PUR 1.5m	3.6V DC	Wired M-Bus	No module	kWh	014U1432

**Ordering**  
**SonoSelect 10 - Combined**  
**Heating and Cooling**

Meter size	Installation	Cable length	Power supply	Integrated communication	Modules	Energy unit	Code No.
DN15 qp0.6m <sup>3</sup> /h G <sup>3</sup> / <sub>4</sub> 110mm	Return	PUR 1.5m	3.6V DC	None	Radio OMS WB 868,95 with 2 pulse inputs	kWh	014U1307
DN15 qp0.6m <sup>3</sup> /h G <sup>3</sup> / <sub>4</sub> 110mm	Return	PUR 1.5m	3.6V DC	Wired M-Bus	2 pulse inputs	kWh	014U1314
DN15 qp0.6m <sup>3</sup> /h G <sup>3</sup> / <sub>4</sub> 110mm	Return	PUR 1.5m	3.6V DC	Wired M-Bus	No module	kWh	014U1300
DN15 qp0.6m <sup>3</sup> /h G <sup>3</sup> / <sub>4</sub> 110mm	Return	PUR 1.5m	230V AC	Wired M-Bus	No module	kWh	014U1334
DN15 qp1.5m <sup>3</sup> /h G <sup>3</sup> / <sub>4</sub> 110mm	Return	PUR 1.5m	3.6V DC	None	Radio OMS WB 868,95 with 2 pulse inputs	kWh	014U1308
DN15 qp1.5m <sup>3</sup> /h G <sup>3</sup> / <sub>4</sub> 110mm	Return	PUR 1.5m	3.6V DC	Wired M-Bus	2 pulse inputs	kWh	014U1315
DN15 qp1.5m <sup>3</sup> /h G <sup>3</sup> / <sub>4</sub> 110mm	Return	PUR 1.5m	3.6V DC	Wired M-Bus	No module	kWh	014U1301
DN15 qp1.5m <sup>3</sup> /h G <sup>3</sup> / <sub>4</sub> 110mm	Return	PUR 1.5m	230V AC	Wired M-Bus	No module	kWh	014U1335
DN20 qp1.5m <sup>3</sup> /h G1 130mm	Return	PUR 1.5m	3.6V DC	None	Radio OMS WB 868,95 with 2 pulse inputs	kWh	014U1309
DN20 qp1.5m <sup>3</sup> /h G1 130mm	Return	PUR 1.5m	3.6V DC	Wired M-Bus	2 pulse inputs	kWh	014U1316
DN20 qp1.5m <sup>3</sup> /h G1 130mm	Return	PUR 1.5m	3.6V DC	Wired M-Bus	No module	kWh	014U1302
DN20 qp1.5m <sup>3</sup> /h G1 130mm	Return	PUR 1.5m	230V AC	Wired M-Bus	No module	kWh	014U1336
DN20 qp2.5m <sup>3</sup> /h G1 130mm	Return	PUR 1.5m	3.6V DC	None	Radio OMS WB 868,95 with 2 pulse inputs	kWh	014U1310
DN20 qp2.5m <sup>3</sup> /h G1 130mm	Return	PUR 1.5m	3.6V DC	Wired M-Bus	2 pulse inputs	kWh	014U1317
DN20 qp2.5m <sup>3</sup> /h G1 130mm	Return	PUR 1.5m	3.6V DC	Wired M-Bus	No module	kWh	014U1303
DN20 qp2.5m <sup>3</sup> /h G1 130mm	Return	PUR 1.5m	230V AC	Wired M-Bus	No module	kWh	014U1337
DN25 qp3.5m <sup>3</sup> /h G1 <sup>1</sup> / <sub>4</sub> 160mm	Return	PUR 1.5m	3.6V DC	None	Radio OMS WB 868,95 with 2 pulse inputs	kWh	014U1311
DN25 qp3.5m <sup>3</sup> /h G1 <sup>1</sup> / <sub>4</sub> 160mm	Return	PUR 1.5m	3.6V DC	Wired M-Bus	2 pulse inputs	kWh	014U1318
DN25 qp3.5m <sup>3</sup> /h G1 <sup>1</sup> / <sub>4</sub> 160mm	Return	PUR 1.5m	3.6V DC	Wired M-Bus	No module	kWh	014U1304
DN25 qp3.5m <sup>3</sup> /h G1 <sup>1</sup> / <sub>4</sub> 160mm	Return	PUR 1.5m	230V AC	Wired M-Bus	No module	kWh	014U1338
DN25 qp3.5m <sup>3</sup> /h G1 <sup>1</sup> / <sub>4</sub> 260mm	Return	PUR 1.5m	3.6V DC	Wired M-Bus	2 pulse inputs	kWh	014U1319
DN25 qp6.0m <sup>3</sup> /h G1 <sup>1</sup> / <sub>4</sub> 260mm	Return	PUR 1.5m	3.6V DC	None	Radio OMS WB 868,95 with 2 pulse inputs	kWh	014U1312
DN25 qp6.0m <sup>3</sup> /h G1 <sup>1</sup> / <sub>4</sub> 260mm	Return	PUR 1.5m	3.6V DC	Wired M-Bus	2 pulse inputs	kWh	014U1320
DN25 qp6.0m <sup>3</sup> /h G1 <sup>1</sup> / <sub>4</sub> 260mm	Return	PUR 1.5m	3.6V DC	Wired M-Bus	No module	kWh	014U1305
DN25 qp6.0m <sup>3</sup> /h G1 <sup>1</sup> / <sub>4</sub> 260mm	Return	PUR 1.5m	230V AC	Wired M-Bus	No module	kWh	014U1339
DN32 qp6.0m <sup>3</sup> /h G1 <sup>1</sup> / <sub>2</sub> 260mm	Return	PUR 1.5m	3.6V DC	None	Radio OMS WB 868,95 with 2 pulse inputs	kWh	014U1313
DN32 qp6.0m <sup>3</sup> /h G1 <sup>1</sup> / <sub>2</sub> 260mm	Return	PUR 1.5m	3.6V DC	Wired M-Bus	2 pulse inputs	kWh	014U1321
DN32 qp6.0m <sup>3</sup> /h G1 <sup>1</sup> / <sub>2</sub> 260mm	Return	PUR 1.5m	3.6V DC	Wired M-Bus	No module	kWh	014U1306
DN32 qp6.0m <sup>3</sup> /h G1 <sup>1</sup> / <sub>2</sub> 260mm	Return	PUR 1.5m	230V AC	Wired M-Bus	No module	kWh	014U1340



**Accessories**

Product	Designation	Quantity	Code No.
Tail piece set PN25 130°C	DN15 R $\frac{1}{2}$ x G $\frac{3}{4}$	1 set	087G6071
Tail piece set PN25 130°C	DN20 R $\frac{3}{4}$ x G1	1 set	087G6072
Tail piece set PN25 130°C	DN25 R1 x G1 $\frac{1}{4}$	1 set	087G6073
Tailpiece connection set	Tailpiece connection set DN15 G3/4"-R1/2" PN16 95°C	1 set	014U1936
Tailpiece connection set	Tailpiece connection set DN20 G1"-R3/4" PN16 95°C	1set	014U1937
Tailpiece connection set	Tailpiece connection set DN25 G1 1/4"-R1" PN16 95°C	1 set	014U1938
Tailpiece connection set	Tailpiece connection set DN32: G1 1/2"-R5/4" PN16 95°C	1set	014U1939
Adapter for temperature sensor	Adapter R $\frac{1}{2}$ " to M10x1 (32pcs.)	32 pcs	014U1935
Adapter for temperature sensor	Adapter R $\frac{1}{2}$ " to M10x1 (1pcs.)	1pc	014U1941
Tee fitting	T-fitting DN15: G $\frac{1}{2}$ ", G $\frac{1}{2}$ ", G $\frac{1}{2}$ " PN25 130°C	1 pc	014U1959
Tee fitting	T-fitting DN20: G $\frac{3}{4}$ ", G $\frac{1}{2}$ ", G $\frac{3}{4}$ " PN25 130°C	1 pc	014U1960
Tee fitting	T-fitting DN25: G1", G $\frac{1}{2}$ ", G1" PN25 130°C	1 pc	014U1961
Tee fitting	T-Fitting DN32: G11/4", G $\frac{1}{2}$ ", G11/4" PN25 130°C	1 pc	014U1943
Adapter for temperature sensor	R $\frac{1}{2}$ x M10 x 1	1pc	014U1935
Adapter for temperature sensor	R $\frac{1}{2}$ x M10 x 1	32 pcs	014U1941
Ball valve	G $\frac{1}{2}$ " internal thread, Pt sensor connection M10	1 pc.	187F0593
Ball valve	G $\frac{1}{2}$ " internal thread, Pt sensor connection M10	12 pcs.	087H0118
Ball valve	G $\frac{3}{4}$ " internal thread, Pt sensor connection M10	1 pc.	187F0592
Ball valve	G $\frac{3}{4}$ " internal thread, Pt sensor connection M10	12 pcs.	087H0119
Ball valve	G1" internal thread, Pt sensor connection M10	1 pc.	187F0591
Ball valve	G1" internal thread, Pt sensor connection M10	12 pcs.	087H0120
Wall mounting kit	Calculator wall mounting	1 set	014U1945
Cable	M-Bus 2 wire cable (22 AWG), 1 m PVC, ferrules	1 pc.	014U1946
Cable	M-Bus 2 wire cable (22 AWG), 2.5 m PVC, ferrules	1 pc.	014U1947
Cable	M-Bus 2 wire cable (22 AWG), 5 m PVC, ferrules	1 pc.	014U1948
Cable	M-Bus 2 wire cable (22 AWG), 9.75 m PVC, ferrules	1 pc.	014U1949
Cable	Pulse input/output 2 wire cable. (22 AWG), 2,5 m PVC, ferrules	1 pc.	014U1950
Cable	Pulse input/output 2 wire cable. (22 AWG), 5 m PVC, ferrules	1 pc.	014U1951
Cable	Pulse input/output 2 wire cable. (22 AWG), 9,75 m PVC, ferrules	1 pc.	014U1952
Extension pipe, L = 60 mm	DN20 x G1	1 pc.	014U1957
Extension pipe, L = 100 mm	DN25 x G1 $\frac{1}{4}$	1 pc.	014U1958
Gasket	DN15	1 set	014U1964
Gasket	DN20	1 set	014U1965
Gasket	DN25	1 set	014U1966
Gasket	DN32	1 set	014U1942
O-ring mounting kit	O-ring Ø4.3 x 2.4 + assembly tool	1 set	014U1967
Battery	Battery pack 1 AA cell	1 pc.	014U1968
Battery	Battery pack 2 AA cell	1 pc.	014U1969
Communication module	M-Bus module with 2 pulse inputs	1 pc.	014U1998
Communication module	Wireless OMS 868.95MHz with 2 pulse inputs	1 pc.	014U1999
Communication module	2 pulse inputs	1 pc.	014U1995
Bluetooth dongle	IR2BLE	1 pc.	014U1963
Sealing kit	4 x wire with + 4 x snap lock seal	1 set	014U1962

\* On request new codes with unique specification combination can be created. If needed please contact you local product manager.





**Danfoss A/S**

Heating Segment • [heating.danfoss.com](http://heating.danfoss.com) • +45 7488 2222 • E-Mail: [heating@danfoss.com](mailto:heating@danfoss.com)

---

Danfoss can accept no responsibility for possible errors in catalogues, brochures and other printed material. Danfoss reserves the right to alter its products without notice. This also applies to products already on order provided that such alterations can be made without subsequential changes being necessary in specifications already agreed. All trademarks in this material are property of the respective companies. Danfoss and all Danfoss logotypes are trademarks of Danfoss A/S. All rights reserved.

---